



PART# 836825
2005+ TOYOTA TACOMA 2WD
2003+ TOYOTA 4RUNNER 2WD
2006+ TOYOTA FJ CRUISER 2WD
2.5" LEVELING KIT



Components
(2) 836825 STRUT SPACER
(8) M10-1.25 FLANGE NUT



2 HOUR INSTALL TIME



Recommended Tire size
 33x11.50

Please double check the parts list before beginning installation to ensure all parts are present. If there is something missing, please contact Maxtrac Suspension (714) 630-0363. Please have the boxes present if parts are missing or damaged

PRIOR TO INSTALLATION:

1. Factory service manual is recommended to have on hand.
2. Secure and properly block vehicle prior to beginning installation.
3. Always wear safety glasses when using power tools or working under the vehicle
- 4 Modification to any part will void the warranty associated with that product

AFTER REMOVING PARTS FROM VEHICLE, SAVE HARDWARE FOR REINSTALLATION

Step 1 Jack up the front of the vehicle and support under the frame rails with jack stands.

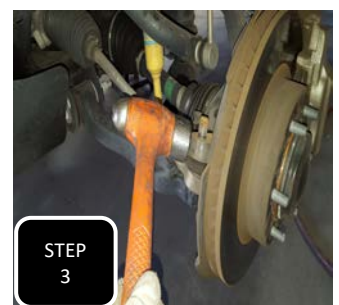
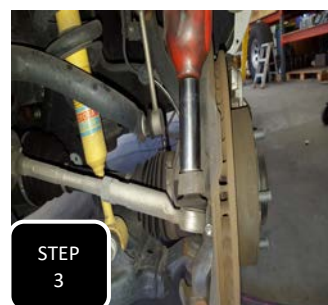
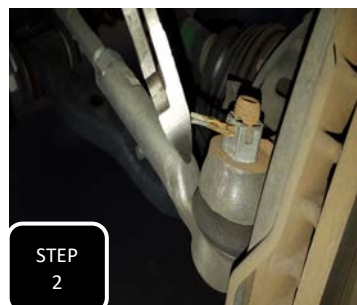
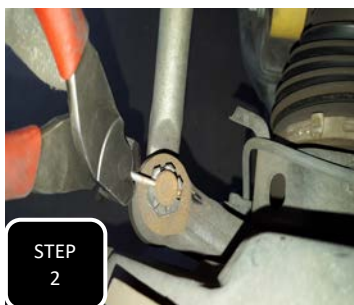

Step 2 Remove the cotter pin that is engaged in the outer tie rod end.

Step 3 Loosen the tie rod nut, then break the tie rod loose by hitting the side of the steering arm with a hammer and separate. **NOTE: NEVER HIT THE TIE ROD ON THE THREADS.**



STEP
4



STEP
4

Step 4 Unbolt the sway bar end link from the neck of the spindle and separate.



STEP
5



STEP
5

Step 5 Loosen and remove the 3 nuts at the top of the strut and the single bolt at the bottom of the strut.



STEP
6



STEP
6

Step 6 Remove the clip at the upper ball joint and then loosen the nut, but do not remove. Break the ball joint loose by hitting the side of the spindle with a hammer, the nut will catch the spindle, then separate. **NOTE: NEVER HIT THE BALL JOINT ON THE THREADS.**



STEP
7



STEP
7

Step 7 Remove the strut and then attach the strut spacer to the top of the strut using the factory nuts and tighten.



STEP
8

Step 8 Re-install the strut assembly back into the truck and loosely attach the hardware at the top and bottom.



STEP
9



STEP
9

Step 9 Place a floor jack under the lower control arm and jack up to compress the coil. Now re-attach the upper control arm to the spindle, tighten the castle nut, and re-install the factory clip.



Step 10 Tighten the provided nuts at the top of the strut and the factory bolt at the bottom.



Step 11 Re-attach the sway bar end link to the spindle and tighten. **NOTE: THIS STEP SHOULD BE DONE AFTER THE SPACERS HAVE BEEN INSTALLED ON BOTH SIDES.**



Step 12 Re-attach the tie rod to the spindle and tighten. Once tight, re-install the factory cotter pin.

