

9915MR

2014 + GM TRUCK FRONT LOWERING MAGNERIDE KIT
DESIGNED TO FIT OUR 2/4, 3/5 AND 4/6 DROP KITS



PARTS LIST:

(2) 9915MR front sensor rods



NOTE: This sensor rod components kit should be installed as the truck is being put back together after installing the lowering kit.

NOTE: If you are only installing drop spindles, the rods will not need to be used.

STEP 1: Separate the front sensor rod from both mounting points and remove.



STEP 2: The plastic rod ends are held onto the sensor rod by a rib engaged into a retaining groove. To separate, tighten the rod into a vise and use a pair of pliers to pry the rod end off. Repeat for both rod ends.



STEP 3: If installing 1" drop coils, you will pop the rod ends onto the new rod as is and install it back onto the truck. **IF NOT, PROCEED TO STEP 4.**

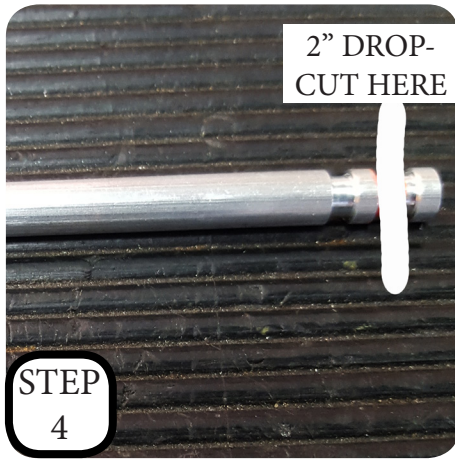

STEP 4: If you are installing 2" drop coils, then you will need to cut off the end of the new rod, right where the first groove ends, then install the rod ends and install back onto the truck.